

Adding A ClustrMaps to Your Blog Sidebar Using The ClustrMaps Widget

The ClustrMaps widget is available to Edublogs Pro and Edublogs Campus users only.

This widget is designed to provide a quick and easy way of adding a ClustrMaps to your blog sidebar without having to grab the HTML embed code from the [ClustrMaps](http://www.clustrmaps.com) website.

It's as simple as adding your email address and agreeing to ClustrMaps terms & conditions!

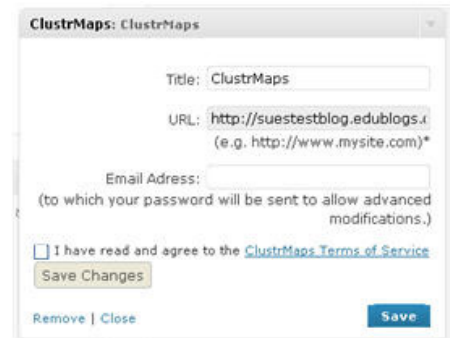

NOTE:

- On free Edublogs blogs you need to follow the instructions for adding ClustrMaps to your sidebar using a text widget (<http://help.edublogs.org/2009/08/10/adding-clustrmaps-to-your-blog-sidebar-using-a-text-widget/>)!

About ClustrMaps

[ClustrMaps](http://www.clustrmaps.com) is a free thumbnail hit counter map widget that shows the location of all visitors to your blog. Number of visitors from a location is indicated by the relative size of the dot.

Clicking the ClustrMaps thumbnail takes you to a large World map so you can examine your traffic sources more closely. To scrutinize even closer, click on each continent on the map.



Activating your ClustrMaps Widget

The ClustrMaps Widget is contained in Widget Pack which you must first activate in your **Plugins** area.

- This widget pack also contains Delicious, Vod Pod, Twitter, Google Search and Flickr widgets.
- Once activated all these widgets will appear in your **available widget area** in your **Appearance > Widget screen** -- ready for you to use.
- If your ClustrMaps disappears from your blog activating your Widget pack immediately returns your ClustrMap to your blog sidebar.



Adding Your ClustrMaps to your Sidebar

1. Go to **Appearance > Widgets** in your Dashboard



2. Click on the desired Sidebar to expand (so you can add the widgets) *NOTE: In new blogs sidebars in your dashboard are empty and adding widgets automatically removes the default Edublogs widgets*

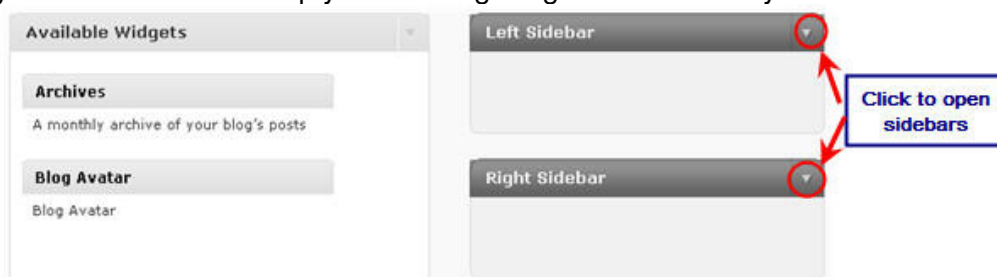

3. To add a ClustrMaps widget, drag it from the **Available Widgets** or **Inactive Widgets** areas on the left into the Sidebar area on the right

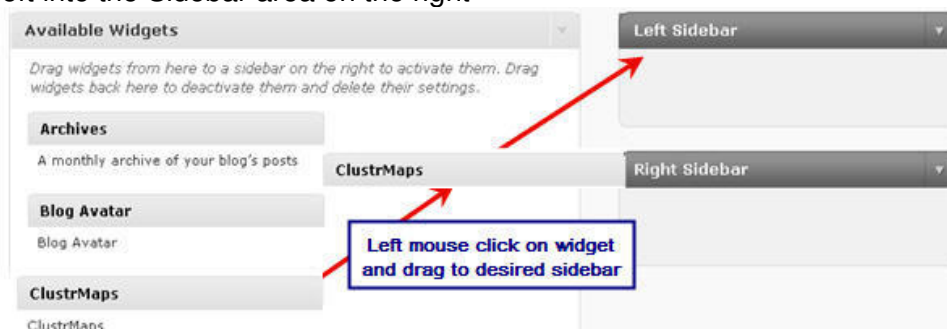

4. Drop the widget when you see a dashed line appear - this indicates the widget is in place



5. The widget will automatically open — add your email address, click on Agree to terms and conditions, and then click **Save Changes**. Final step is **Save** and then **Close**. (If you have trouble with the text widget or it doesn't open — try changing your theme just in case there is an issue with it).

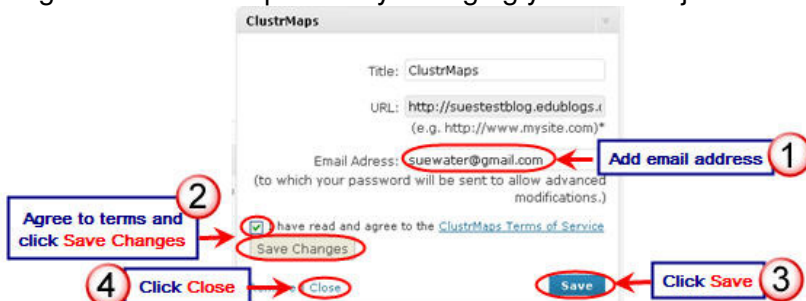

6. You will receive an email advising of successful widget registration and your widget will look like this image in your sidebar -- dots won't appear for 24 hours.

